



**OWNER'S  
MAINTENANCE  
AND ADJUSTMENT  
GUIDELINES**

**OPTIMA / EURO ALU DOOR**

*October 2020*

## **Recommended Maintenance Schedule For Your Optima / Euro Alu Door**

### **In General**

Regular cleaning and maintenance will help to keep the beauty and prolong the functionality of your Euro Alu doors. Adjust the doors as required.

Salt and other corrosive or abrasive materials must not be allowed to build up on the exterior surfaces or components.

Any damage to the exterior surfaces, such as scratches, chips or abrasions can result in corrosion and should be repaired.

\*At no time should a pressure washer be used to clean Euro Alu doors.

### **Cleaning Glass**

- **As required**

Use a mild, ph-neutral cleaning product with a clean soft cloth and/or squeegee. Outside reflexive surfaces must not be cleaned with any caustic or alkaline substances or cleaning powders, as they will damage the surface.

### **Cleaning, Maintaining and Lubricating Hardware**

- **Once a year**

If necessary, tighten any loose screws and replace any defective parts.

Lubrication: (See below for instructions)

For difficult to operate units, it is most likely a hardware adjustment issue. Please consult the diagrams below for adjustments. If you continue to have problems, contact us and we will be happy to give you some guidance.

### **Cleaning Wood Frames and Aluminum Cladding**

- **Twice a year, preferably spring and fall**

During cleaning the outdoor temperature should not exceed 25°C.

Aluminum surfaces should be thoroughly cleaned using a mild or slightly alkaline cleaning product and warm water (not hot). Remove any buildup around the silicone seal at the perimeter of the glass. Immediately wipe the surface with clean, cold water. Then dry thoroughly.

Wood frames can be cleaned with a soft cloth which is slightly damp with water. Dry with a soft cloth. Avoid abrasive cleaners or pads as these can damage the finish on the aluminum or wood.

### **Cleaning Door Thresholds**

- **As required**

Keep dirt and debris off the threshold, as this can damage the weather stripping. Vacuum excess material from the threshold as needed, and wipe clean with a damp rag. If the door is rubbing the threshold there may be debris stuck under the door, or it could need adjustment.

### **Cleaning and Maintaining Gaskets**

- **Once a year**

Clean gaskets will ensure that the sash seals tightly to the frame. Using mild soap and warm water (not hot), clean the gaskets and dry thoroughly. You can re-dress the gaskets with a silicone spray, but be sure to apply this to the rag rather than the gasket directly, as any overspray can affect the finish. Gaskets should be replaced if damaged.

## Adjustments

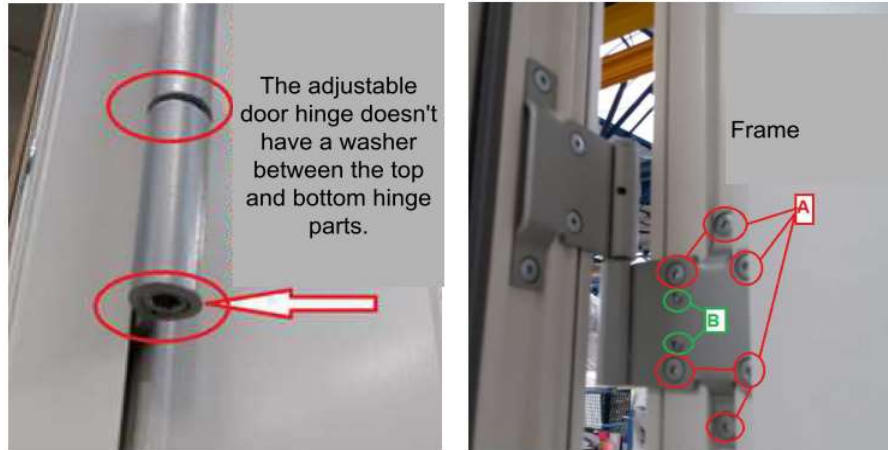

The adjustable hinges include a vertical adjustment screw (+/- 2mm) as shown in the left picture above. The hinges can be also adjusted in a horizontal direction using the screws marked with the letter B in the picture above, on the right. The adjustable hinges have no washers between the top and bottom hinge parts to allow vertical adjustment.

### Adjustment Tools:

In order to make adjustments, you will need the following tools:

1. Allen key 6mm
2. Allen key 3mm
3. Torx 20



### IMPORTANT:

The adjustment of adjustable hinges with a hinge wrench must never be done because of the risk of damage to the hinges.



1. **Vertical Adjustment** - Use the 6mm Allen key to adjust the hinges in a vertical direction. The adjustment range is +/- 2mm. Once the desired height is achieved, all adjustment screws should be tightened to make sure that all the hinges work evenly.



## 2. Horizontal Adjustment

a) Open the sash and using the Torx 20, loosen the the six screws (shown with the letter A below).

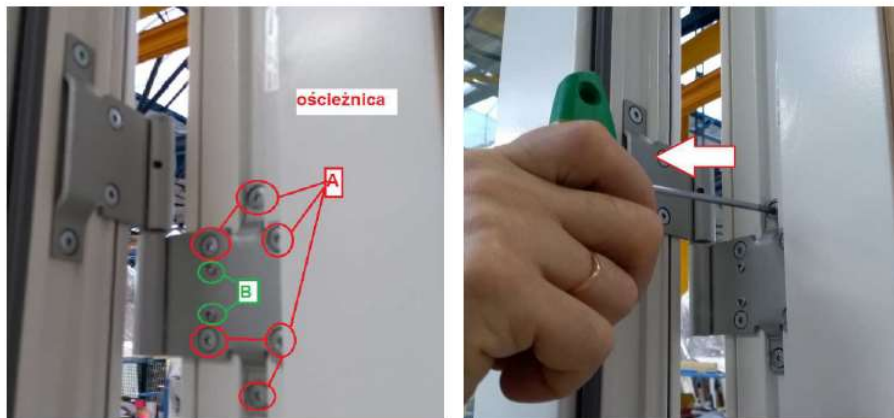

b) Next, using the 3mm Allen key, rotate the set screws (shown with the letter B above), ensuring that the adjustments are done evenly so the door is not twisted.



c) Using a Torx 20 screwdriver, tighten all previously loosened screws (shown with the letter A above).

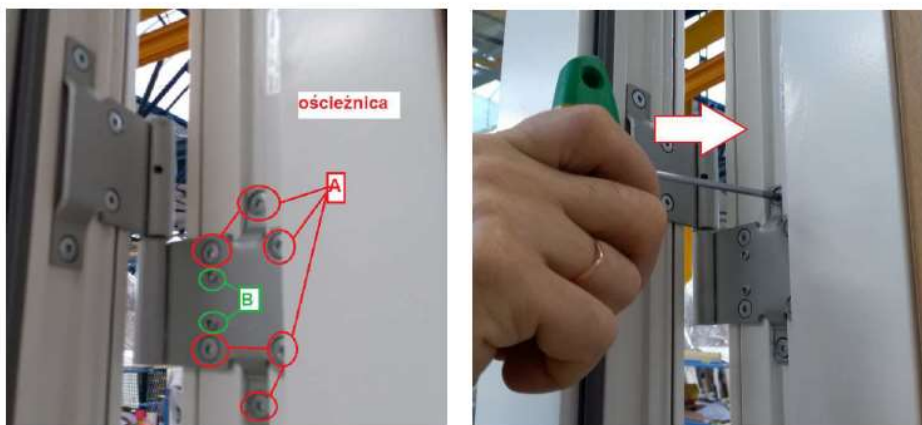

### Lubrication

Lubricate once a year, as indicated.  
Use **only** a clean, non-resinous grease or oil (i.e. 3 in 1).



## Installation of the Hoppe handle on a Euro Alu door



## Removal of the Hoppe handle on a Euro Alu door

Insert installation key into the small hole on the handle. Gently pull the key towards you. Pull both handles out to remove. (Installation keys come with all handles). For more information watch this short video:

[https://www.youtube.com/watch?v=t\\_1TUx0JPqs&list=UU9tCpIV-c9ZOynMs4HvnVRg&index=1](https://www.youtube.com/watch?v=t_1TUx0JPqs&list=UU9tCpIV-c9ZOynMs4HvnVRg&index=1)

